

RIG PLATFORM

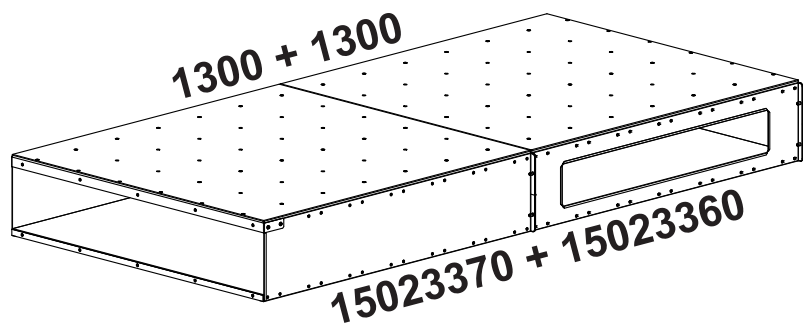

Installation Manual

Manual 15023388_A

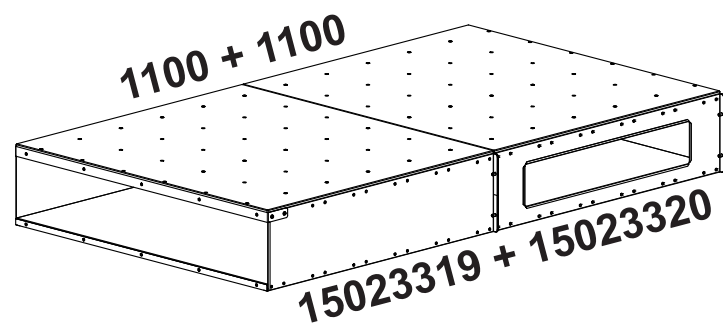
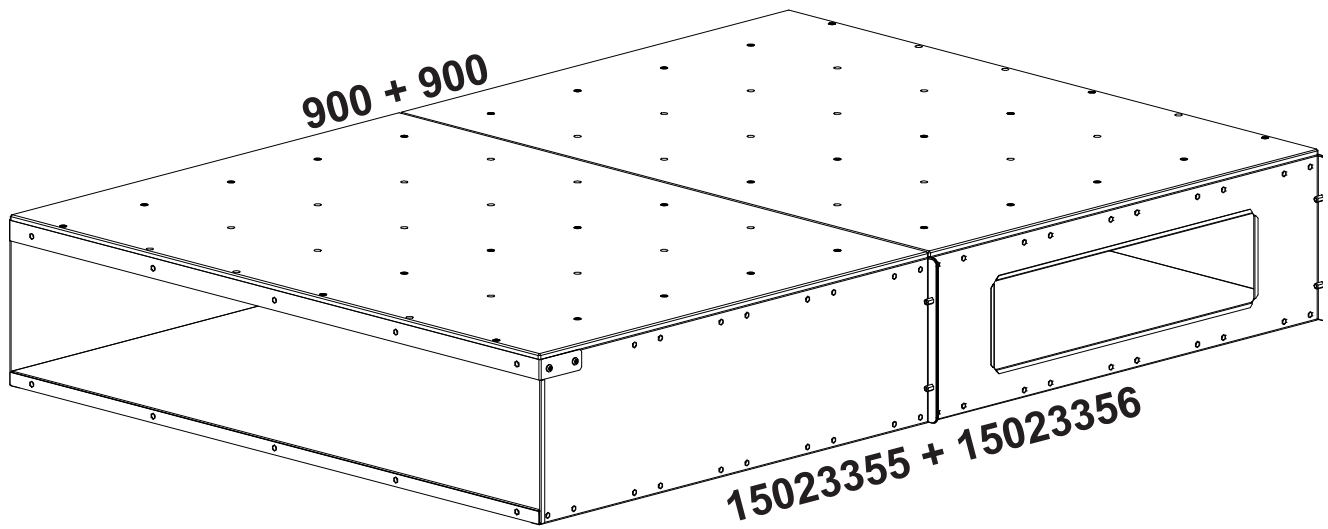

Loyds Industri AS - 2023-12-08

Accepted cars				
Year	Make	Model	Accepted	Update
2006	VW	Transporter T5	2023-08-02	
2020	VW	Transporter T6	2023-09-15	
2016+	Toyota	Proace L1	2023-11-15	

Revision Record						
Rev nr	Date	Page	Picture	Update	New	Deleted steps
A	2023-12-08				X	

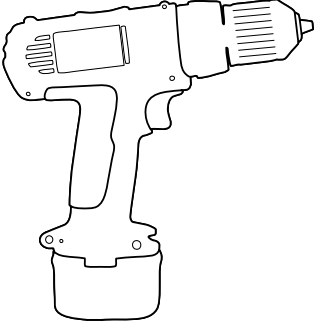

Use colors when printing this installation manual. / Ved utskrift, bruk farger.

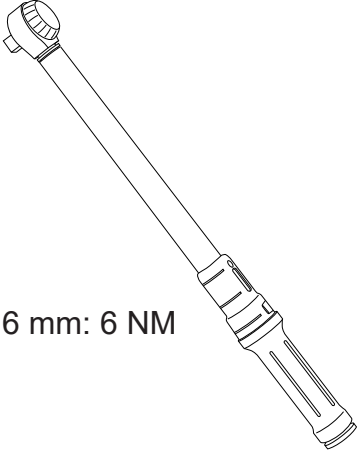
Tools		
	 <div>TX30</div>	 <div>6 mm: 6 NM</div>

15023355 + 15023356 Rig Platform

Example is platform 900 + 900

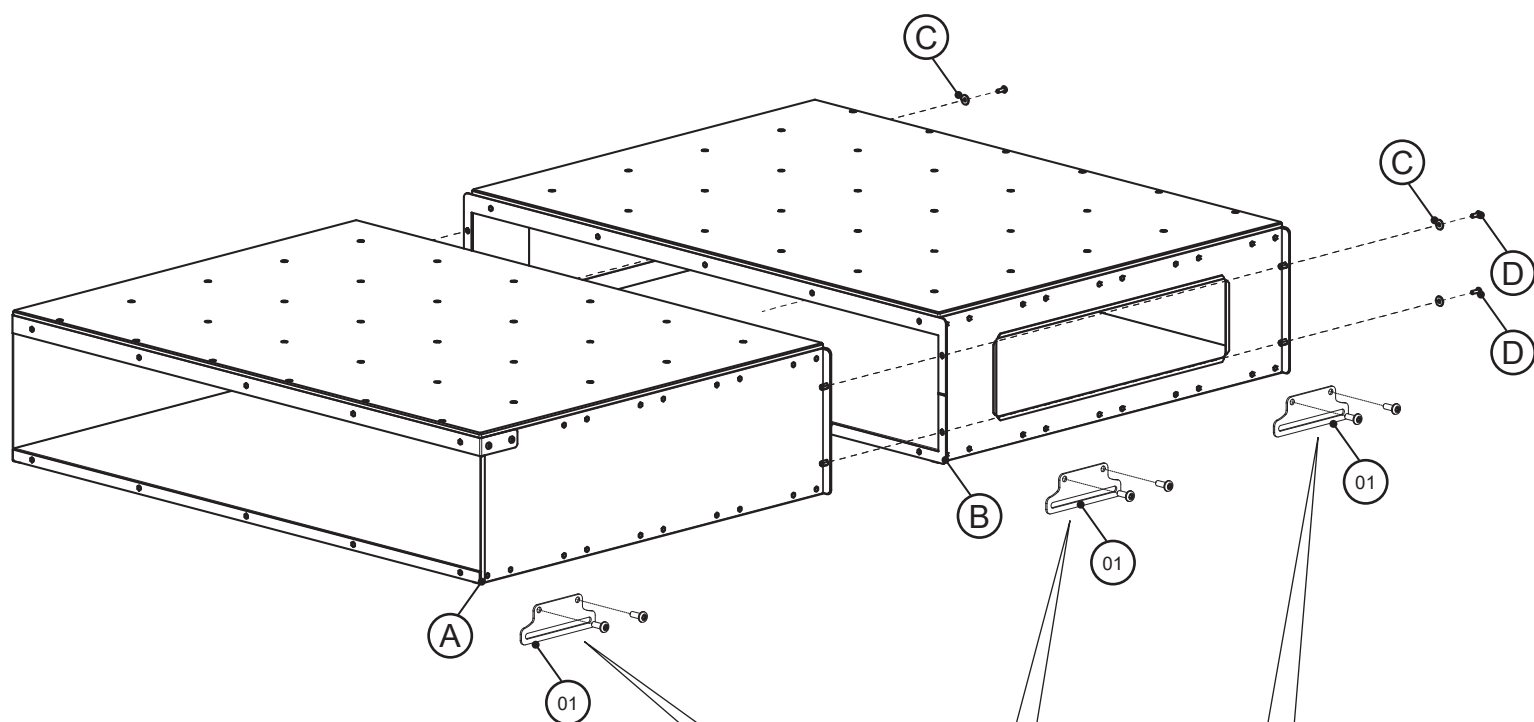

INCLUDED IN BASE:
15023380_A RIG BASE UNIVERSAL ASSEMBLY

Number	Quantity	Part Number	Definition
A	1	15023355	Rig Platform Rear module 900x1200x220
B	1	15023356	Rig Platform Front module 900x1200x220
C	4	6,4x18x1,5	M6 Washer, DIN 9021
D	4	15003551	M6x16 TX30 pan (DIN 7985)

1 BASE (15023380) MUST BE FITTED IN THE CAR

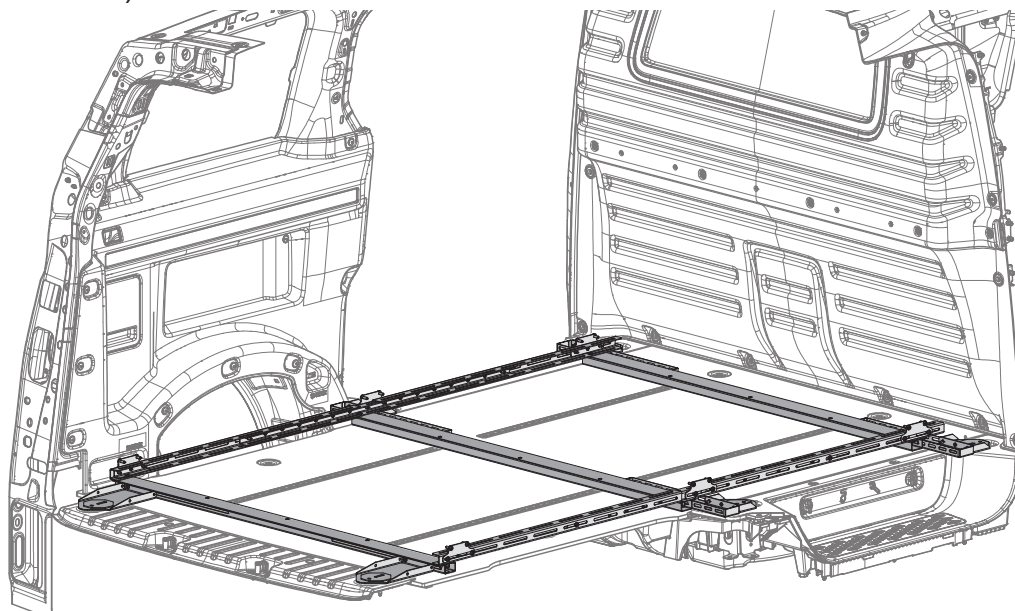

2 CHECK THAT ALL ATTACHMENT EARS (01) TO THE PLATFORM ARE IN PLACE

Careful with the wheel arches

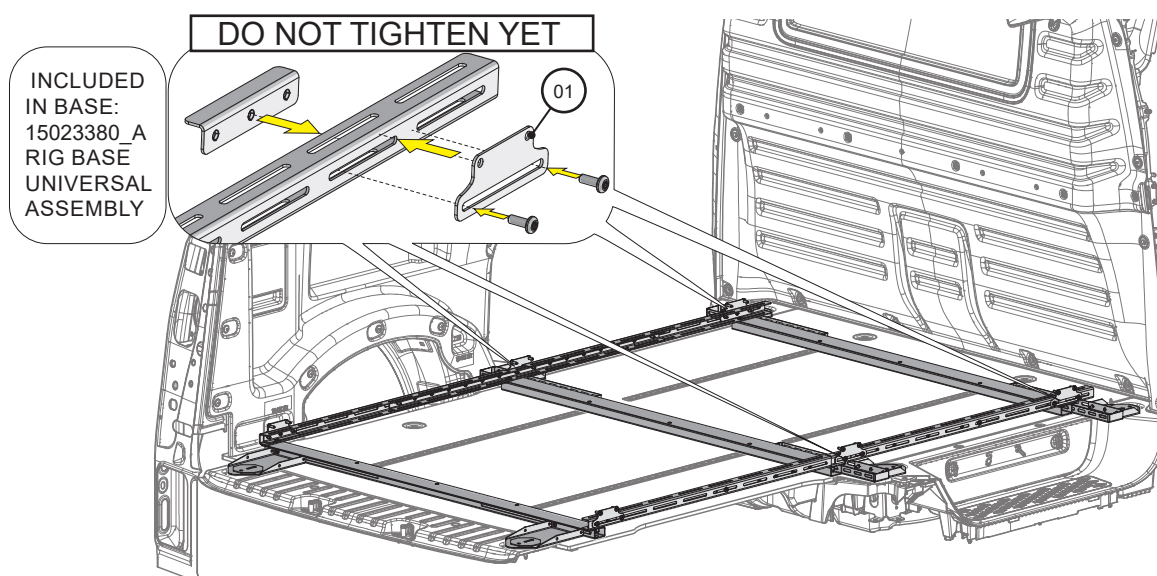

3 LIFT IN FRONT PLATFORM (15023356) ON BASE

Careful with the wheel arches

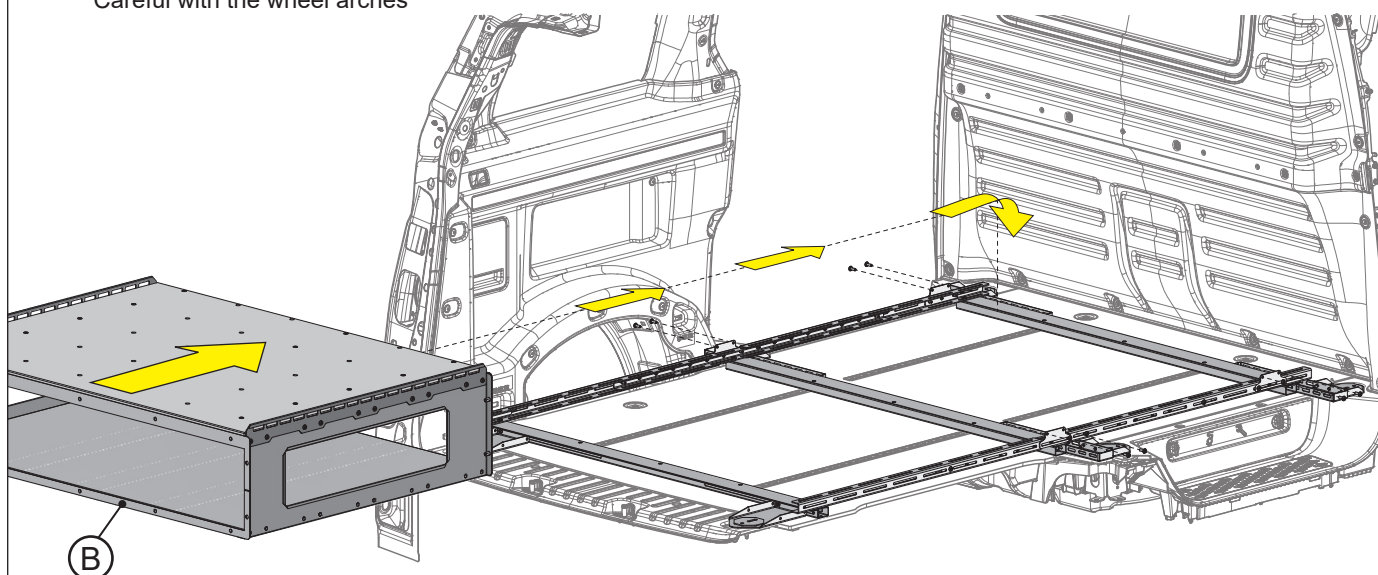

4 FIT THE FRONT PLATFORM (15023356) ON THE BASE

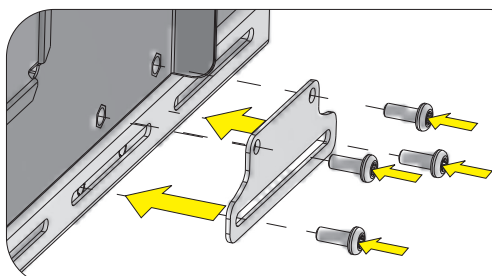

INCLUDED
IN BASE:
15023380_A
RIG BASE
UNIVERSAL
ASSEMBLY

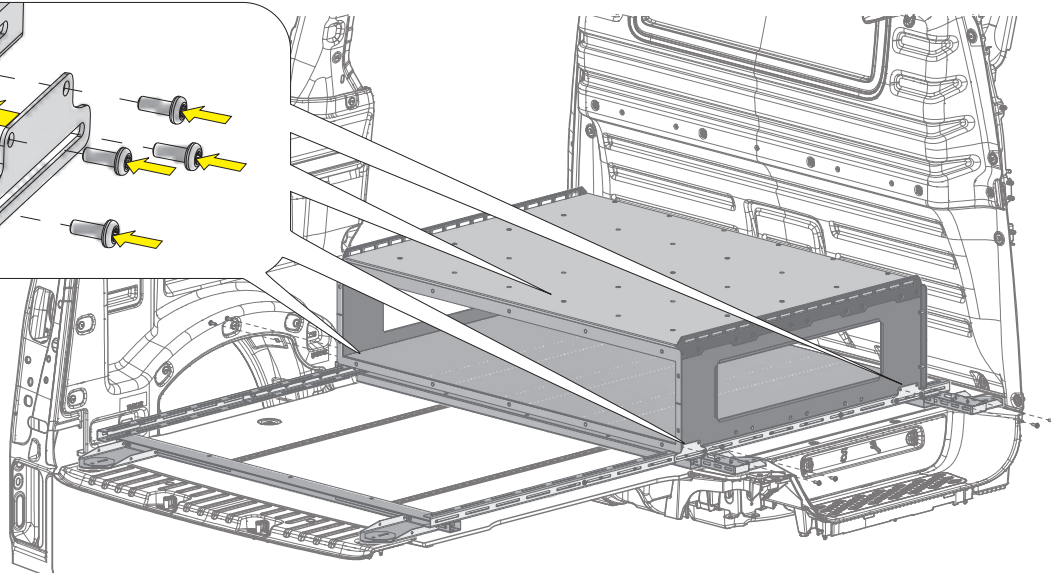

5 LIFT IN REAR PLATFORM (15023355) ONTO BASE

Be careful with the wheel arches

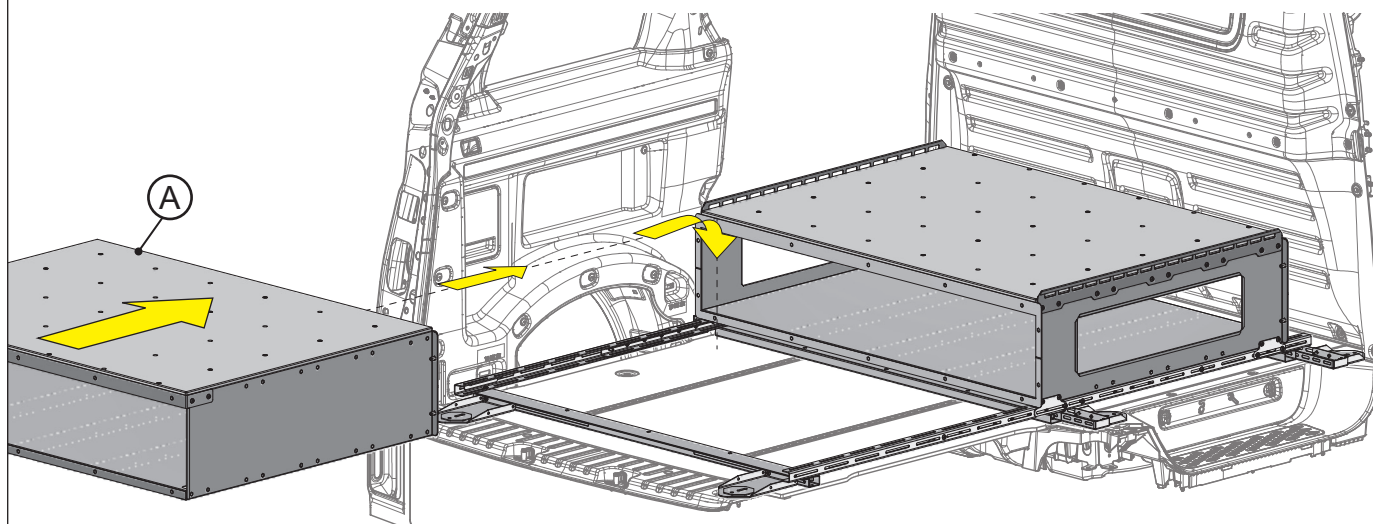

6 ALIGN PLATFORMS AND TIGHTEN SCREWS (D)

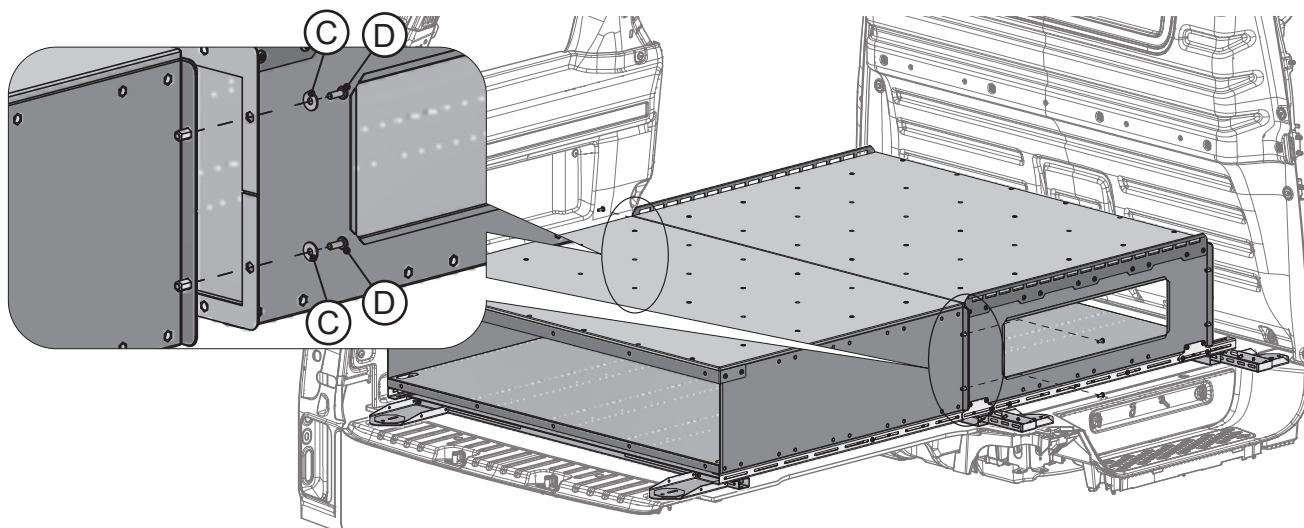

7 INSTALLATION IN CARS WITH A HEATER OR SMALL SPACES BEHIND THE WHEEL ARCHES

INCLUDED
IN BASE:
15023380_A RIG
BASE UNIVER-
SAL ASSEMBLY

INCLUDED IN BASE:
15023380_A RIG BASE
UNIVERSAL ASSEMBLY

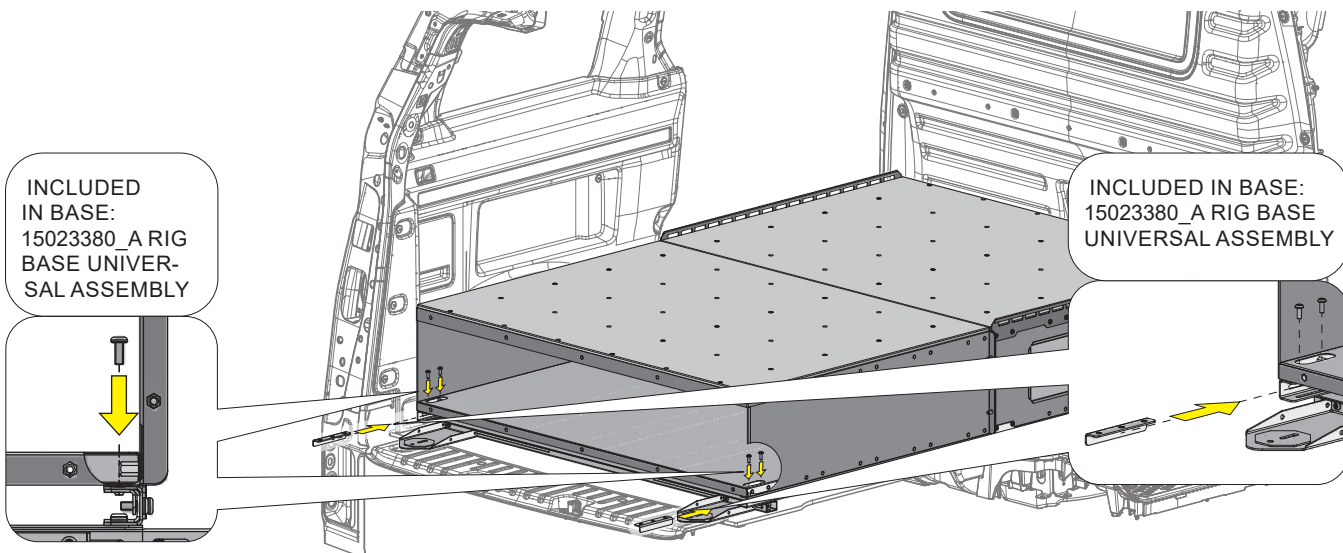

8 ASSEMBLY IN CARS WITH OPEN SPACES REAR OF WHEEL ARCHES

INCLUDED IN BASE:
15023380_A RIG BASE
UNIVERSAL ASSEM-
BLY

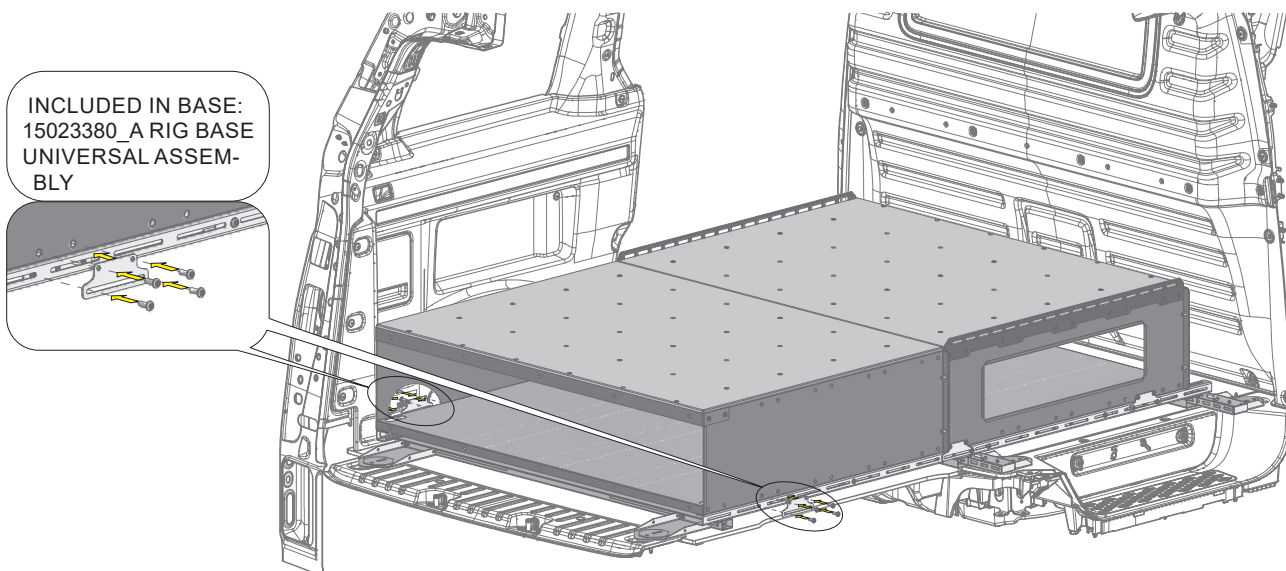

9 NEXT IS ASSEMBLY OF DRAWER

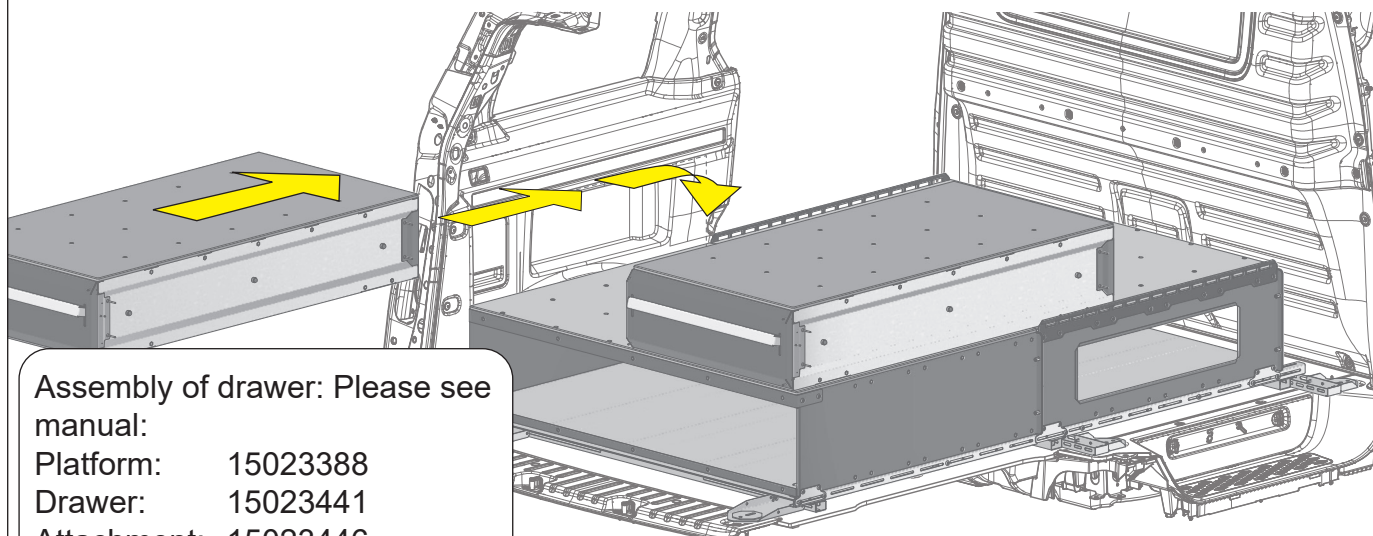

Assembly of drawer: Please see
manual:

Platform: 15023388

Drawer: 15023441

Attachment: 15023446